

## A spacious house with a beautiful garden and a garage in a gated community.

Bišu 9, Rīgas rajons

Deal: BUY

Type: Houses

Total Area: 291 m<sup>2</sup>

Land Area: 1521 m<sup>2</sup>

Sale Price: 350000 €

Spacious and Warm House with a Garden, Garage, and Solar Panels in the Gated Community of Spilve.

This house was built in 2013 using keramzit concrete blocks. It is well-insulated, with a metal tile roof and PVC windows. The roof has recently undergone maintenance. The interior features high-quality finishes, parquet floors, and bright color schemes. The home is move-in ready for its new owners.

Ground Floor Layout:

- Entrance terrace – 28.6 m<sup>2</sup>
- Garage – 36 m<sup>2</sup>, with automatic doors and space for two vehicles. Direct access to the house...



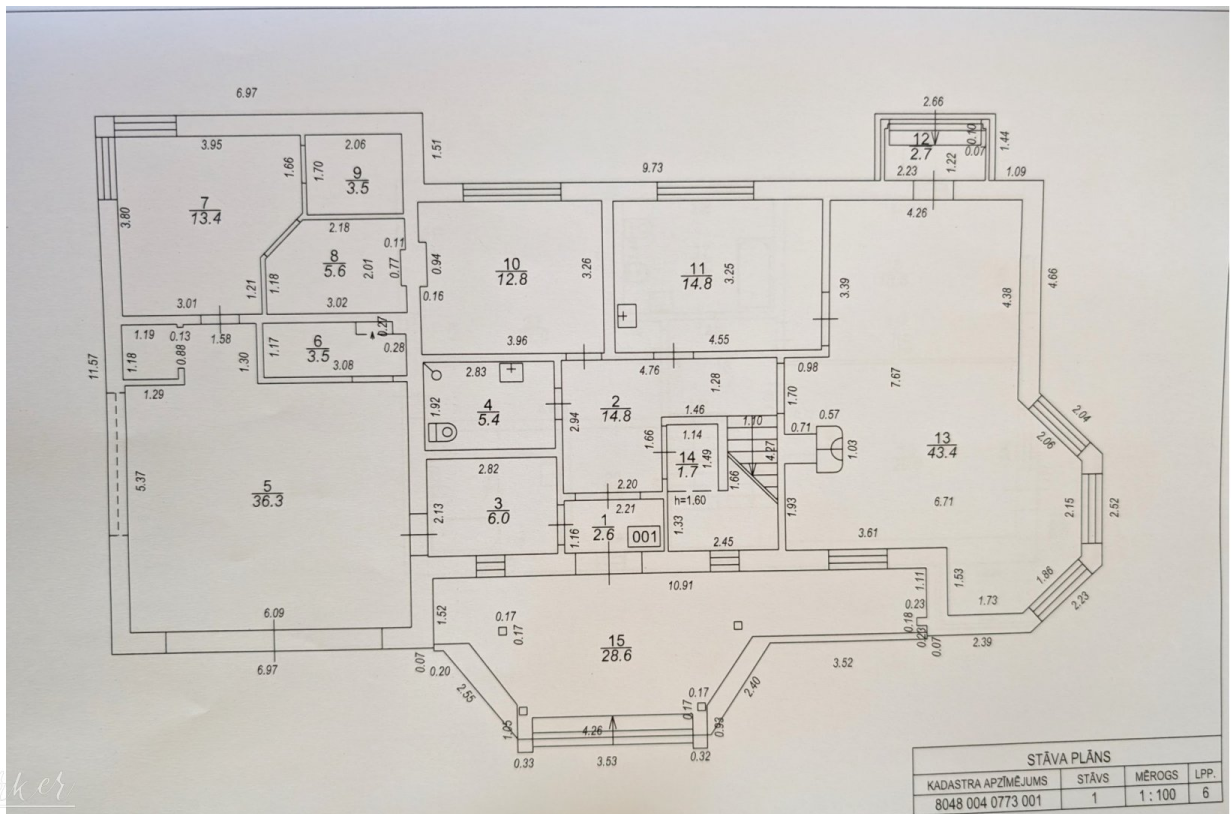

Location

