

## For residential or agricultural use.

Kokāres , Bauska un rajons

Deal: BUY

Type: Land

Land Area: 6100 m<sup>2</sup>

Sale Price: 14200 €

Agricultural arable land is offered in Iecava municipality, next to the settlement "Rosme", on an area of 0,61 ha. Possibility to use for agriculture or for the construction of a homestead.

Agricultural area ( L ):

Maximum building density:

20%,

Building height: 12m (or according to technological need);

Minimum area of the newly created plot: 2 ha;

Number of residential buildings on the land plot: 1 homestead.

Land plot use: Homestead building, agricultural production enterprise building, agricultural use.

Additional uses of the plot...



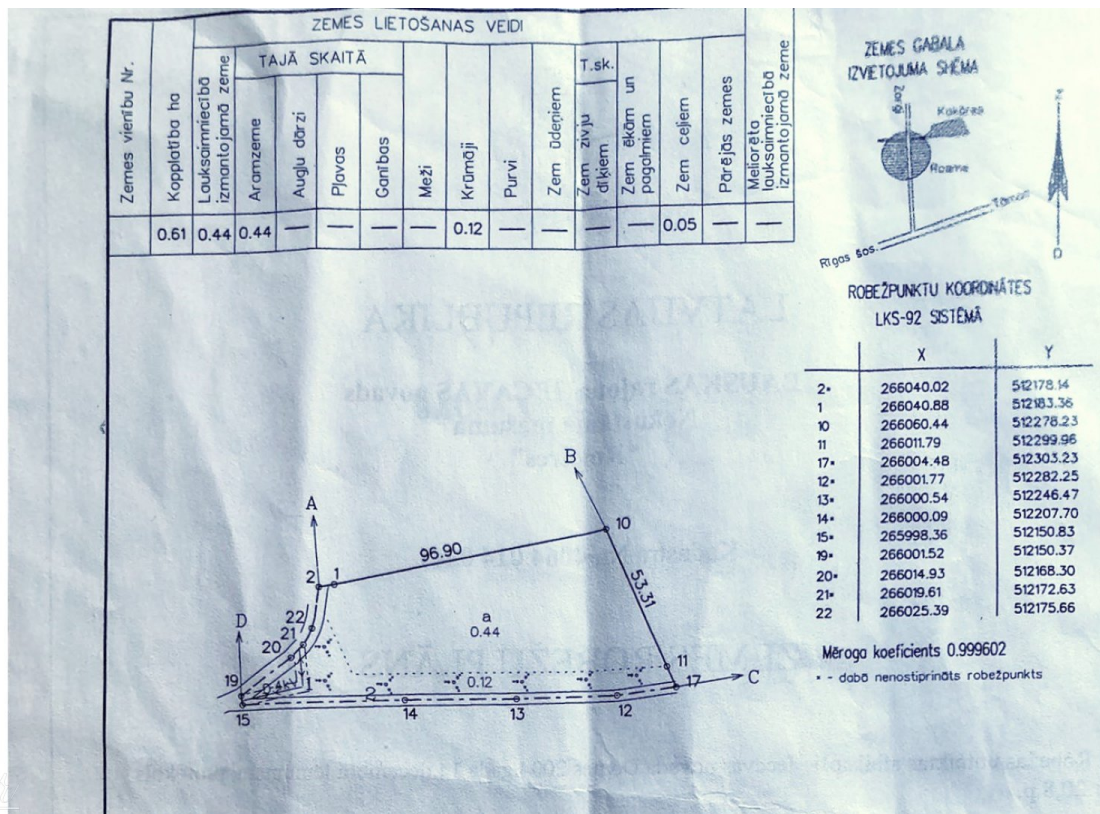

Location

